

**Pioneer** *sound.vision.soul*

**Multi-channel AV processor**

多聲道 AV 處理機

English

中文

---

**Operation Manual**

**DEQ-P7050**

**使用說明書**

## Thank you for buying this Pioneer product.

Please read through these operating instructions so you will know how to operate your model properly. *After you have finished reading the instructions, put them away in a safe place for future reference.*

### 01 Before You Start

About this unit **3**

- Dolby Digital/DTS compatibility (when combining this unit with a Pioneer DVD player such as DVH-P7050) **3**

About this manual **3**

Precautions **3**

Resetting the microprocessor **4**

Output setting of the DVD player **4**

What's what **5**

- Head Unit **5**

### 02 Audio Adjustments

Introduction of audio adjustments **6**

- Operating the audio menu **6**
- Operating the audio details menu **6**

Using the sound field control **7**

Using the position selector **7**

Using balance adjustment **8**

Adjusting source levels **8**

Using the dynamic range control **9**

Using the dual mono mode **9**

Using the direct control **9**

Using the Dolby Pro Logic **9**

Setting the speaker setting **10**

- Correcting the subwoofer's phase **10**

Selecting a cut-off frequency **11**

Adjusting the speaker output levels **11**

Adjusting the speaker output levels using a test tone **12**

Adjusting the time alignment **13**

Using the equalizer **13**

- Recalling equalizer curves **13**
- Adjusting 3-band parametric equalizer **14**

### 03 Initial Settings

Correcting distorted sound **15**

### 04 Additional Information

Troubleshooting **16**

- Common **16**
- Audio/DSP **17**
- DVD player setting **17**

Terms **18**

Specifications **19**

## Before You Start

### About this unit

#### **Dolby\* Digital/DTS\*\* compatibility (when combining this unit with a Pioneer DVD player such as DVH-P7050)**

When using this unit with a Pioneer DVD player, you can enjoy the atmosphere and excitement provided by DVD movie and music software featuring 5.1 channel recordings.



\* Manufactured under license from Dolby Laboratories. "Dolby", "Pro Logic", and the double-D symbol are trademarks of Dolby Laboratories.

\*\* "DTS" and "DTS Digital Surround" are registered trademarks of Digital Theater Systems, Inc. ■

### About this manual

This unit features a number of sophisticated functions ensuring superior reception and operation. All the functions have been designed for the easiest possible use, but many are not self-explanatory. This operation manual will help you benefit fully from this unit's potential and to maximize your listening enjoyment.

We recommend that you familiarize yourself with the functions and their operation by reading through the manual before you begin using this unit. It is especially important that you read and observe the precautions listed on this page and in other sections. ■

### Precautions

- Keep this manual handy as a reference for operating procedures and precautions.
- Always keep the volume low enough so you can hear sounds outside of the car.
- Protect this unit from moisture.
- If the battery is disconnected or discharged, the preset memory will be erased and must be reprogrammed.
- Should this unit fail to operate properly, contact your dealer or nearest authorized Pioneer Service Station. ■

## Resetting the microprocessor

The microprocessor must be reset under the following conditions:

- Prior to using this unit for the first time after installation.
- If the unit fails to operate properly.
- When strange or incorrect messages appear on the display.

• **To reset the microprocessor, press the RESET button on the unit with a pen tip or other pointed instrument.**

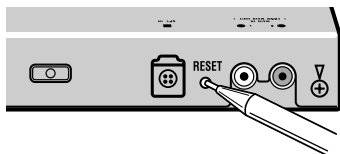

## Output setting of the DVD player

When connecting Pioneer DVD player such as DVH-P7050, make **DIGITAL OUTPUT** (*Setting for digital output*) and **OUTPUT SELECTION** (*Setting digital and analog audio output*) as follows:

Function	Setting
<b>DIGITAL OUTPUT</b>	<b>Dolby D/LPCM</b>
<b>OUTPUT SELECTION</b>	<b>48KHz</b>

Refer to the DVD player manual for details on how to make those settings.



### Important

- Be sure to set the correct position. If not, no audio can be outputted. 

## Before You Start

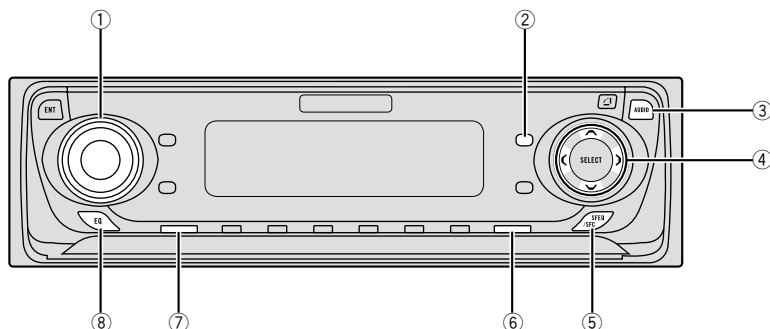

### What's what

Operate this unit with the connected head unit. Instructions in this operation manual use DVH-P7050 as an example head unit.

### Head Unit

#### ① VOLUME

Turn to adjust the volume.  
When you press the **VOLUME**, it extends outward so that it becomes easier to turn.  
To retract the **VOLUME**, press it again.

#### ② FUNCTION button

Press to select functions.

#### ③ AUDIO button

Press to select an audio function.

#### ④ ▲/▼/◀/▶ buttons

Press to adjust the selected audio function and turn it on or off.

#### ⑤ SFEQ/SFC button

Press to select a sound field control.

#### ⑥ BAND/ESC button

Press to return to the display of each source.

#### ⑦ SOURCE button

This unit is switched on by selecting a source. Press to cycle through all of the available sources. Press and hold to turn off the unit.

#### ⑧ EQ button

Press to select an equalizer curve.

## Introduction of audio adjustments

By carrying out the following settings/adjustments in order, you can create a finely-tuned sound field effortlessly.

- 1 *Setting the speaker setting*
- 2 *Using the position selector*
- 3 *Adjusting the time alignment*
- 4 *Adjusting the speaker output levels using a test tone*
- 5 *Selecting a cut-off frequency*
- 6 *Adjusting the speaker output levels*
- 7 *Adjusting 3-band parametric equalizer*

### Operating the audio menu



#### ① AUDIO display

Shows the audio adjustments status.

#### ② Subwoofer indicator

Appears in the display when the subwoofer output is turned on.

### Press **AUDIO** to display the audio function names.

Press **AUDIO** repeatedly to switch between the following audio functions:

**Posi** (position selector)—**Fad** (balance adjustment)—**SLA** (source level adjustment)—**DRC** (dynamic range control)—**D.MONO** (dual monaural)—**DIRECT** (direct)—**DolbyPL** (Dolby Pro Logic)

- When selecting the FM tuner as the source, you cannot switch to **SLA**.
- When playing other than the DVD disc, you cannot switch to **DRC** or **D.MONO**.
- To return to the playback display, press **BAND/ESC**.



#### Note

- If you do not operate the audio function within about 30 seconds, the display is automatically returned to the source display.

### Operating the audio details menu

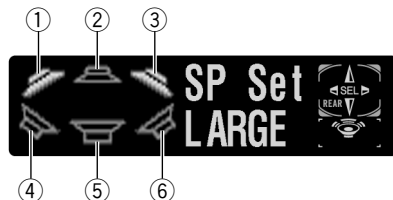

#### ① Front left speaker

#### ② Center speaker

#### ③ Front right speaker

#### ④ Rear left speaker

#### ⑤ Subwoofer

#### ⑥ Rear right speaker

**Press AUDIO and hold until SP Set appears in the display, then press AUDIO to display the audio function names.**

After **SP Set** is displayed, press **AUDIO** repeatedly to switch between the following audio functions:

## Audio Adjustments

**SP Set** (speaker setting)—**CutOff** (cut-off frequency)—**SP Lev** (speaker output level)—**T Tone** (test tone)—**Time A** (time alignment)—**PEQ** (3-band parametric equalizer)

- When neither **F/L** nor **F/R** is selected in **Posi**, you cannot switch to **Time A**.
- When neither **CUSTOM1** nor **CUSTOM2** is selected as equalizer curve, you cannot switch to **PEQ**.
- To return to the playback display, press **BAND/ESC**. 

### Using the sound field control

The SFC function creates the sensation of a live performance.

- The acoustics of different performance environments are not the same and depend on the extent and contour of space through which sound waves move and on how sounds bounce off the stage, walls, floors and ceilings. At a live performance you hear music in three stages: direct sound, early reflections, and late reflections, or reverberations.

Those factors are programed into the SFC circuitry to recreate the acoustics of various performance settings.

#### Press **SFEQ/SFC** to select the desired **SFC** mode.

Press **SFEQ/SFC** repeatedly to switch between the following mode:

**Musical** (musical)—**Drama** (drama)—**Action** (action)—**Jazz** (jazz)—**Hall** (hall)—**Club** (club)—**OFF** (off)



#### Note

- If the source is a 2-channel LPCM audio or a 2-channel Dolby Digital audio and you select SFC effects that are most applicable for 5.1-channel audio (i.e., **Musical**, **Drama** or **Action**), we recommend switching Dolby Pro Logic on. On the other hand, when selecting SFC effects that are intended for use with 2-channel audio (i.e., **Jazz**, **Hall** or **Club**), we recommend switching Dolby Pro Logic off. 

### Using the position selector

One way to assure a more natural sound is to clearly position the stereo image, putting you right in the center of the sound field. The position selector function lets you automatically adjust the speaker output levels and inserts a delay time to match the number and position of occupied seats. When used in conjunction with the SFC, the feature will make the sound image more natural and offer a panoramic sound that envelops you.

#### 1 Press **AUDIO** to select **Posi**.

Press **AUDIO** until **Posi** appears in the display.

#### 2 Press **▲/▼/◀/▶** to select a listening position.

Press one of these, **◀/▶/▲/▼**, to select a listening position as listed in the table.

Button	Display	Position
◀	<b>F/L</b>	Front seat left
▶	<b>F/R</b>	Front seat right
▲	<b>FRONT</b>	Front seats
▼	<b>ALL</b>	All seats

- To cancel the selected listening position, press the same button again.

**Note**

- When you make adjustments for listening position, the speakers are automatically set for appropriate output levels. You can tailor them if you want as discussed under the heading of *Adjusting the speaker output levels using a test tone* or *Adjusting the speaker output levels*.

## Using balance adjustment

You can select a fader/balance setting that provides an ideal listening environment in all occupied seats.

### 1 Press **AUDIO** to select **Fad**.

Press **AUDIO** until **Fad** appears in the display.

- If the balance setting has been previously adjusted, **Bal** will be displayed.

### 2 Press **▲** or **▼** to adjust front/rear speaker balance.

Each press of **▲** or **▼** moves the front/rear speaker balance to the front or the rear.

- **Fad F25 – Fad R25** is displayed as the front/rear speaker balance moves from front to rear.
- **Fad F/R 0** is the proper setting when only two speakers are used.

### 3 Press **◀** or **▶** to adjust left/right speaker balance.

When you press **◀** or **▶**, **Bal L/R 0** is displayed.

Each press of **◀** or **▶** moves the left/right speaker balance to the left or the right.

- **Bal L25 – Bal R25** is displayed as the left/right speaker balance moves from left to right.

## Adjusting source levels

SLA (source level adjustment) lets you adjust the volume level of each source to prevent radical changes in volume when switching between sources.

- Settings are based on the FM tuner volume level, which remains unchanged.

### 1 Compare the **FM** tuner volume level with the level of the source you want to adjust.

### 2 Press **AUDIO** to select **SLA**.

Press **AUDIO** until **SLA** appears in the display.

### 3 Press **▲** or **▼** to adjust the source volume.

Each press of **▲** or **▼** increases or decreases the source volume.

- **SLA +4 – SLA -4** is displayed as the source volume is increased or decreased.

**Notes**

- Since the FM tuner volume is the control, it is not possible to apply source level adjustments to the FM tuner.
- The AM tuner volume level can also be adjusted with source level adjustments.
- Video CD and CD are set to the same volume adjustment setting automatically.
- External unit 1 and external unit 2 are set to the same volume adjustment setting automatically.



## Audio Adjustments

### Using the dynamic range control

The dynamic range refers to the difference between the largest and softest sounds. The dynamic range control compresses this difference so that you can clearly hear sounds even at low volume levels.

#### 1 Press **AUDIO** to select **DRC**.

Press **AUDIO** until **DRC** appears in the display.

#### 2 Press **▲** to turn the dynamic range control on.

**DRC ON** appears in the display. Dynamic range control is now on.

- You can turn off dynamic range control by pressing **▼**.



#### Notes

- The dynamic range control is effective only on Dolby Digital sounds.
- When playing other than the DVD disc, you cannot switch this mode.

### Using the dual mono mode

When playing a disc recorded on a dual mono mode, you can select the channel to output.

#### 1 Press **AUDIO** to select **D.MONO**.

Press **AUDIO** until **D.MONO** appears in the display.

#### 2 Press **◀** or **▶** to select the desired output setting.

Press **◀** or **▶** until the desired output setting appears in the display.

**L&R** (left and right channels)—**L ch** (left channel)—**R ch** (right channel)



#### Notes

- This function is effective only on dual mono mode sound.
- When playing other than the DVD disc, you cannot switch this mode.

### Using the direct control

You can override audio settings to check for effectiveness of your audio settings.

#### 1 Press **AUDIO** to select **DIRECT**.

Press **AUDIO** until **DIRECT** appears in the display.

#### 2 Press **▲** to turn the direct control on.

**DIRECT ON** appears in the display. Direct control is now on.

- You can turn off direct control by pressing **▼**.



#### Note

- All audio functions are locked out during **DIRECT ON** except **VOLUME**.

### Using the Dolby Pro Logic

Dolby Pro Logic gives enhanced spatial and directional effects, creating theater-like sense of presence and ambience.

- If the source is a 2-channel LPCM audio or a 2-channel Dolby Digital audio and you select SFC effects that are most applicable for 5.1-channel audio (i.e., **Musical**, **Drama** or **Action**), we recommend switching Dolby Pro Logic on. On the other hand, when selecting SFC effects that are intended for use with 2-channel audio (i.e., **Jazz**, **Hall** or **Club**), we recommend switching Dolby Pro Logic off.

## Audio Adjustments

### 1 Press **AUDIO** to select **DolbyPL**.

Press **AUDIO** until **DolbyPL** appears in the display.

### 2 Press **▲** to turn the **Dolby Pro Logic on**.

**DolbyPL ON** appears in the display. Dolby Pro Logic is now on.

- You can turn off Dolby Pro Logic by pressing **▼**.



#### Note

- When playing a 2-channel mono source with Pro Logic switched on, there may be occasions when the following will occur:

No audio is outputted if the center speaker setting is **SMALL** or **LARGE** while no center speaker is installed.

Audio is heard only over the center speaker if installed and the center speaker setting is

**SMALL** or **LARGE**.

## Setting the speaker setting

You need to make with/without (or yes/no) and size (bass reproducing capacity) selection/adjustments depending on the installed speakers. The size needs to be set to **LARGE** (large) if the speaker is capable of reproducing sounds of about 100 Hz or below. Otherwise select **SMALL** (small).

### 1 Press **AUDIO** and hold until **SP Set** appears in the display.

### 2 Press **◀** or **▶** to select the speaker to be adjusted.

Each press of **◀** or **▶** selects the speaker in the following order:

Front speakers—Center speaker—Rear speakers—Subwoofer—**S.W** (subwoofer setting)

- You can switch to the **S.W**, only when the subwoofer has been set to **ON**.

### 3 Press **▲** or **▼** to select the correct size for the selected speaker.

Press **▲** or **▼** until the desired size appears in the display.

**LARGE** (large)—**SMALL** (small)—**OFF** (off)

- You cannot select **OFF**, when the front speakers have been selected.
- You can switch **ON** or **OFF**, when the subwoofer has been selected.
- You can switch **Rev.** (reverse phase) or **Normal** (normal phase), when **S.W** (subwoofer setting) has been selected.

### 4 Press **BAND/ESC** to return to the playback display.

## Correcting the subwoofer's phase

If trying to boost the bass output of the subwoofer doesn't do much or rather makes you feel that the bass gets more murky, this may indicate that the subwoofer's output and bass content you hear over other speakers cancel each other out. To remove this problem, try changing the phase setting for the subwoofer.

### 1 Press **AUDIO** and hold until **SP Set** appears in the display.

### 2 Press **◀** or **▶** to select the subwoofer.

Press **◀** or **▶** selects the speaker in the following order:

Front speakers—Center speaker—Rear speakers—Subwoofer—**S.W** (subwoofer setting)

## Audio Adjustments

3 Press **▲** to turn the subwoofer output on.

4 Press **▶** to select **S.W** (subwoofer setting).

5 Press **▲** or **▼** to select the subwoofer output phase.

Press **▲** to select **Normal** (normal phase).

Press **▼** to select **Rev.** (reverse phase).

6 Press **BAND/ESC** to return to the playback display.



### Important

- Low frequency range is not outputted if the subwoofer is set to **OFF** and the front and rear speakers set to **SMALL** or **OFF**.



### Notes

- It is imperative that non-installed speakers be set to **OFF**.
- Set the front or rear speaker to **LARGE** if the speaker is capable of reproducing bass content, or if no subwoofer is installed.
- When playing a 2-channel mono source with Pro Logic switched on, there may be occasions when the following will occur:  
No audio is outputted if the center speaker setting is **SMALL** or **LARGE** while no center speaker is installed.  
Audio is heard only over the center speaker if installed and the center speaker setting is **SMALL** or **LARGE**.

## Selecting a cut-off frequency

You can select a frequency, under which sounds are reproduced through the subwoofer.

If the installed speakers include one whose size has been set to **SMALL**, you can select a frequency, under which sounds are reproduced through a **LARGE** speaker or subwoofer.

1 Press **AUDIO** and hold until **SP Set** appears in the display, then press **AUDIO** to select **CutOff**.

After **SP Set** is displayed, press **AUDIO** until **CutOff** appears in the display.

2 Press **◀** or **▶** to select the cut-off frequency.

Each press of **◀** or **▶** selects the cut-off frequency in the following order:

**63—80—100—125—160—200** (Hz)

- Press **◀** or **▶** until the desired frequency appears in the display.

3 Press **BAND/ESC** to return to the playback display.



### Note

- Selecting a cut-off frequency is to set a cut-off frequency of the subwoofer's L.P.F. (low-pass filter) and that of the **SMALL** speaker H.P.F. (high-pass filter). Cut-off frequency setting has no effect if the subwoofer is set to **OFF** and any other speaker is set to **LARGE** or **OFF**.

## Adjusting the speaker output levels

You can readjust the speaker output levels once adjusted using a test tone while listening to music at the time.

1 Press **AUDIO** and hold until **SP Set** appears in the display, then press **AUDIO** to select **SP Lev**.

After **SP Set** is displayed, press **AUDIO** until **SP Lev** appears in the display.

## 2 Press ◀ or ▶ to select the speaker to be adjusted.

Each press of ◀ or ▶ selects the speaker in the following order:

Front speaker left—Center speaker—Front speaker right—Rear speaker right—Rear speaker left—Subwoofer

- You cannot select speakers whose size is set **OFF**.

## 3 Press ▲ or ▼ to adjust the speaker output level.

Each press of ▲ or ▼ increases or decreases the speaker output level.

- **+10** — **-10** is displayed as the level is increased or decreased.

## 4 Press BAND/ESC to return to the playback display.



### Note

- To adjust the speaker output levels at this mode is the same as making the speaker output levels at **T Tone**. Both provide the same results. 

## Adjusting the speaker output levels using a test tone

A convenient test tone allows you to easily get the overall balance right among the speakers.

### 1 Press **AUDIO** and hold until **SP Set** appears in the display, then press **AUDIO** to select **T Tone**.

After **SP Set** is displayed, press **AUDIO** until **T Tone** appears in the display.

### 2 Press ▶ to start the test tone output.

The test tone is outputted. It rotates from speaker to speaker in the following sequence at intervals of about 2 seconds. The current settings for the speaker over which you hear the test tone are shown in the display.

Front speaker left—Center speaker—Front speaker right—Rear speaker right—Rear speaker left—Subwoofer

Check each speaker output level. If no adjustments are needed, perform step 4 to stop the test tone.

- The settings do not appear for speakers whose size is set **OFF**.

### 3 Press ▲ or ▼ to adjust the speaker output level.

Each press of ▲ or ▼ increases or decreases the speaker output level.

- **+10** — **-10** is displayed as the level is increased or decreased.
- The test tone rotates to the next speaker after about 2 seconds from the last operation.

### 4 Press ◀ to stop the test tone output.

### 5 Press **BAND/ESC** to return to the playback display.



### Notes

- If needed, select speakers and adjust their 'absolute' output levels, see *Adjusting the speaker output levels* on page 11.
- To adjust the speaker output levels at this mode is the same as making the speaker output levels at **SP Lev**. Both provide the same results. 

## Audio Adjustments

### Adjusting the time alignment

By adjusting the distance between each speaker and a selected listening position, you can insert delay times into the speaker output to obtain a correct sound image and overall level balance. Although this is automatically achieved when you set the listening position, the time alignment feature provides a fine adjustment.

#### 1 Press **AUDIO** and hold until **SP Set** appears in the display, then press **AUDIO** to select **Time A**.

After **SP Set** is displayed, press **AUDIO** until **Time A** appears in the display.

- You cannot select **Time A** when neither **F/L** nor **F/R** is selected in **Posi**.

#### 2 Press ◀ or ▶ to select the speaker to be adjusted.

Each press of ◀ or ▶ selects the speaker in the following order:

Front speaker left—Center speaker—Front speaker right—Rear speaker right—Rear speaker left—Subwoofer

- You cannot select speakers whose size is set **OFF**.

#### 3 Press ▲ or ▼ to adjust the distance between the selected speaker and the listening position.

Each press of ▲ or ▼ increases or decreases the distance.

- **500.0cm** — **0.0cm** is displayed as the distance is increased or decreased.

#### 4 Press **BAND/ESC** to return to the playback display.

### Using the equalizer

The parametric equalizer lets you adjust the equalization to match car interior acoustic characteristics as desired.

#### Recalling equalizer curves

There are seven stored equalizer curves which you can easily recall at any time. Here is a list of the equalizer curves:

Display	Equalizer curve
<b>SUPER BASS</b>	Super bass
<b>POWERFUL</b>	Powerful
<b>NATURAL</b>	Natural
<b>VOCAL</b>	Vocal
<b>FLAT</b>	Flat
<b>CUSTOM1, 2</b>	Custom1, 2

- **CUSTOM1** and **CUSTOM2** are adjusted equalizer curves that you can create for yourself.
- When **FLAT** is selected no supplement or correction is made to the sound. This is useful to check the effect of the equalizer curves by switching alternatively between **FLAT** and a set equalizer curve.

#### Press **EQ** to select the equalizer.

Press **EQ** repeatedly to switch between the following equalizer.

**POWERFUL**—**NATURAL**—**VOCAL**—**FLAT**—**CUSTOM1**—**CUSTOM2**—**SUPER BASS** 

## Adjusting 3-band parametric equalizer

For **CUSTOM1** and **CUSTOM2** equalizer curves, you can adjust the front, rear and center equalizer curves separately by selecting a center frequency, an equalizer level and a Q factor for each band.

- A separate **CUSTOM1** curve can be created for each source.
- A **CUSTOM2** curve can be created common to all sources.
- The center speaker largely determines the sound image and getting the balance right isn't easy. We recommend reproducing a 2-ch. audio (a CD for example) and getting the balance right among the speakers except for the center, and then reproducing a 5.1-ch. audio (Dolby Digital or DTS) and adjusting the center speaker output to the balance you have already got among the other speakers.

### 1 Press **AUDIO** and hold until **SP Set** appears in the display, then press **AUDIO** to select **PEQ**.

After **SP Set** is displayed, press **AUDIO** until **PEQ** appears in the display.

- You cannot select **PEQ** when neither **CUSTOM1** nor **CUSTOM2** equalizer curve is selected.

### 2 Press **◀** or **▶** to select the speaker selection mode.

Each press of **◀** or **▶** selects the item in the following order:

**FRONT** (speakers)—**Low** (bands)—**Low** (center frequency)—**L** (equalizer level)—**Q.WIDE** (Q factor)

### 3 Press **▲** or **▼** to select the speaker to be adjusted.

Each press of **▲** or **▼** selects the speaker in the following order:

**FRONT** (front speakers)—**CENTER** (center speaker)—**REAR** (rear speakers)

- You cannot select speakers whose size is set **OFF**.

### 4 Press **▶** and then press **▲** or **▼** to select the equalizer band to be adjusted.

Each press of **▲** or **▼** selects the equalizer band in the following order:

**Low** (low)—**Mid** (mid)—**High** (high)

### 5 Press **▶** and then press **▲** or **▼** to select the center frequency of selected band.

Each press of **▲** or **▼** selects the frequency in the following order:

**100—125—160—200—250—315—400—500—630—800—1k—1.25k—1.6k—2k—2.5k—3.15k—4k—5k—6.3k—8k** (Hz)

### 6 Press **▶** and then press **▲** or **▼** to adjust the equalizer level.

Each press of **▲** or **▼** increases or decreases the equalizer level.

- **+6—-6** is displayed as the level is increased or decreased.

### 7 Press **▶** and then press **▲** or **▼** to select the desired Q factor.

Each press **▲** or **▼** switches between the following Q factor:

**Q.WIDE** (wide)—**Q.NAR.** (narrow)

- You can adjust parameters for each band of the other speakers in the same way.

### 8 Press **BAND/ESC** to return to the playback display.



#### Note

- You can select a center frequency from among 20 frequencies for each band. You can change the center frequency in 1/3-octave steps, but you cannot select frequencies so that there are intervals shorter than 1 octave among the three bands' center frequencies.



## Initial Settings

### Correcting distorted sound

You can minimize distortion likely caused by the equalizer curve settings.

- Setting an equalizer level high can cause distortion. If high sound is crippled or distorted, try switching to **Low**. Normally, leave the setting at **High** to ensure quality sound.

**1 Press SOURCE and hold until this unit turns off.**

**2 Press FUNCTION and hold until a function name appears in the display.**

**3 Press FUNCTION to select D.ATT.**

Press **FUNCTION** until **D.ATT** appears in the display.

**4 Press ◀ or ▶ to select Low or High.**

Pressing ◀ or ▶ switches between **Low** (low) and **High** (high) and that status is displayed.

- To cancel initial settings, press **BAND/ESC**.
- You can also cancel initial settings by holding down **FUNCTION** until the unit turns off. 

## Troubleshooting

### Common

Symptom	Cause	Remedy
The power switch does not work. No functions come on.	Cables or connectors are not correctly connected.	Check whether the cables are plugged in correctly and firmly.
	The fuse is blown.	Remove the cause of the blowing of the fuse, then replace the fuse. Be very sure the same rated proper fuse is installed.
No sounds are heard. The volume level will not rise.	Cables are not connected correctly.	Connect the cables correctly.
	The front, rear, left and right speakers are not properly adjusted in level balance.	Adjust the relative levels between the speakers correctly. (See page 8.)
Sound is not heard over a specific speaker.	The speaker size is set to <b>OFF</b> .	Make the correct size setting for the speaker. (See page 10.)
	The speaker level is set to too low.	Increase the speaker level setting to get the balance right with the other speakers. (See page 11.)
	The center speaker size is set to <b>SMALL</b> or <b>LARGE</b> whereas no center speaker is installed.	Set the center speaker size to <b>OFF</b> . (See page 10.)



## Additional Information

### Audio/DSP

Symptom	Cause	Remedy
Speakers are not available to be adjusted.	Their size settings is at <b>OFF</b> .	Make the correct size settings. (See page 10.)
Time alignment is not available.	Listening position is not set correctly.	Set listening position correctly. (See page 7.)
	Their size settings is at <b>OFF</b> .	Make the correct size settings. (See page 10.)
The subwoofer is not available to switch its phase.	The subwoofer is set to <b>OFF</b> .	Set the subwoofer to <b>ON</b> . (See page 10.)
Bass content is not heard.	The subwoofer is set to <b>OFF</b> and yet other speakers are set to <b>OFF</b> or <b>SMALL</b> in size.	Make the correct settings. (If no subwoofer is installed, the front or rear speaker needs to be set to <b>LARGE</b> .) (See page 10.)
Occasionally no sounds are outputted when Dolby Pro Logic is switched on.	The center speaker setting is at <b>SMALL</b> or <b>LARGE</b> whereas no center speaker is installed.	Change the center speaker size setting to <b>OFF</b> . (If the audio source is mono and Dolby Pro Logic is switched on, sound is heard over the center speaker only.) (See page 10.)
Occasionally no sounds are heard over speakers other than the center one.	Dolby Pro Logic is switched on.	Set Dolby Pro Logic to <b>OFF</b> . (If the audio source is mono and Dolby Pro Logic is switched on, sound is heard over the center speaker only.) (See page 9.)
Switching dynamic range control on has no effects.	The currently reproduced sound is not Dolby Digital coded.	The feature is only effective on Dolby Digital sounds. (See page 9.)

### DVD player setting

Symptom	Cause	Remedy
No sounds come from the DVD player only.	The optical cable has become detached.	Connect the cable correctly.
	The DVD player is not properly set for output.	Make the correct output setting. (See the manual for the DVD player.)



## Terms

### Dolby Digital

Dolby Digital provides discrete multichannel (up to a maximum of 5.1) audio. This is the same audio system as is installed in movie theaters. To enjoy Dolby Digital sound you need to connect this unit's optical digital input to the digital output on a DVD player with Dolby Digital decoding capability.



### Dolby Surround Pro Logic

When you play a 2-channel audio disc marked Dolby Surround Pro Logic using an AV amplifier equipped for Dolby Pro Logic, the audio is converted into 4-channel audio.

Dolby Pro Logic gives enhanced spatial and directional effects, creating theater-like sense of presence and ambience.



### DTS for Digital Theater Surround

DTS is a surround system delivering multi-channel audio from up to 6 independent sources. To hear DTS discs, you need to connect the digital output on DTS-capable DVD players and other units to this unit's digital input.



### Dynamic Range Control

Dolby Digital has a function for compressing the difference between the loudest and softest sounds: Dynamic Range Control. This control ensures sounds with an increased dynamic range are heard clearly even at low volume levels.

### Linear PCM (LPCM) /Pulse Code Modulation

This is a recording technology used on music CDs. Some DVD-Video discs also contain PCM sound tracks. While music CDs are recorded at 44.1 kHz/16 bits, DVD-Video discs' sound tracks are recorded at 48 kHz/16 bits to 96 kHz/24 bits, thereby offering better quality audio than music CDs.

### Optical Digital Input

By receiving optical digital input audio signals in a digital signal format, the chance is minimized that the sonic quality deteriorates in the course of transmission. An optical digital input is an input designed to receive digital signals optically. (To take advantage of the digital input, output units such as DVD players must have optical outputs.)

## Additional Information

### Specifications

#### General

Power source .....	14.4 V DC (10.8 – 15.1 V allowable)
Grounding system .....	Negative type
Max. current consumption:	
Backup current .....	10 A
Dimensions (W × H × D) ....	237 × 29 × 171 mm
Weight .....	1.05 kg

#### Amplifier

Continuous power output is 22 W per channel min. into 4 ohms, both channels driven 50 to 15,000 Hz with no more than 5% THD.

Maximum power output ..... 50 W × 5

Load impedance ..... 4 Ω

Preout maximum output level

..... 5.0 V

Decoder

..... Linear PCM/Dolby  
Digital/Dolby Pro  
Logic/DTS

Subwoofer output:

Crossover frequency

..... 63/80/100/125/160/200 Hz

Level ..... ±10 dB

Speaker setting:

Time alignment ..... 0 – 500 cm (2.5 cm)

Level ..... ±10 dB

Equalizer:

Band ..... 3 band

Frequency ..... 100/125/160/200/250/315/  
400/500/630/800/1k/1.25k/  
1.6k/2k/2.5k/3.15k/4k/5k/  
6.3k/8k Hz

Gain ..... ±12 dB

Crossover frequency

..... 63/80/100/125/160/200 Hz



#### Note

- Specifications and the design are subject to possible modifications without notice due to improvements. ▣

## 感謝惠購先鋒產品。

請通讀本使用說明書，以了解本機的正确操作方法。閱讀完畢後，請妥善保存，以備日後參考。

### 01 開始使用之前

關於本機 3

- 杜比數碼/DTS相容（當本機與DVH-P7050等先鋒DVD播放機組合使用時） 3

關於本說明書 3

注意事項 3

重設微處理機 4

DVD播放機的輸出設置 4

按鈕功能 5

- 主機 5

### 02 音頻調節

音頻調節簡介 6

- 操作音頻菜單 6
- 操作音頻資料菜單 6

使用音場控制 7

使用位置選擇器 7

使用平衡調節 8

調節音源級 8

使用動態範圍控制 9

使用雙重單聲道模式 9

使用直接控制 9

使用杜比專業邏輯 9

進行揚聲器設置 10

- 矯正超低音揚聲器相位 10

選擇截止頻率 11

調節揚聲器的輸出音壓 11

使用測試音調節揚聲器的輸出音壓 12

調節時間校正 13

使用等化器 13

- 調出等化器曲線 13
- 調節3頻帶參量等化器 14

### 03 初始設置

矯正失真聲音 15

### 04 附加資訊

故障追尋 16

- 一般問題 16

- 音響/DSP 17

- DVD播放器設定 17

術語 18

規格 19

## 開始使用之前

### 關於本機

#### 杜比\*數碼/DTS\*\*相容（當本機與DVH-P7050 等先鋒DVD播放機組合使用時）

當本機與一臺先鋒 DVD 播放機一起使用時，您可以盡情享受 DVD 影碟和帶有 5.1 聲道錄音的音樂軟體所產生的氛圍和激動人心的效果。



\* 經杜比實驗室授權生產。“杜比”，“Dolby”，“Pro Logic”和雙D標志是杜比實驗室的商標。

\*\* “DTS”和“DTS Digital Surround”為 Digital Theater Systems, Inc. 註冊商標。



### 關於本說明書

本機擁有一系列高級功能，確保高效的接收和操作。所有這些功能都是為簡化操作而設計的，但是大多數功能未自帶說明。本操作說明書將幫助您全面充分發揮本產品的最佳性能，讓您獲得最大的聽覺享受。

我們建議您在開始使用本機之前先通讀本說明書，以熟悉產品的功能及相關操作。而且尤為重要的是要閱讀並遵循本頁及其它章節中所列的注意事項。▣

### 注意事項

- 請將本說明書保存於隨手可取之處，以備操作步驟及注意事項之參考。
- 請務必保持較低的音量，以便聽見車外的聲響。
- 請勿使本產品受潮。
- 如果電池未接通或電量用完，預設記憶將被抹去，須重新編制。
- 若無法正常操作本產品，請與經銷商或臨近的先鋒特約服務中心聯系。▣

## 重設微處理機

下列情況發生時，微處理機必須進行重設：

- 安裝後第一次使用本機之前。
- 若本機無法正常工作。
- 當有異常或錯誤的資訊出現在顯示屏上時。
- 要重設微處理機，請用鋼筆尖或其他帶尖頭的工具按本機上的RESET（重設）鈕。

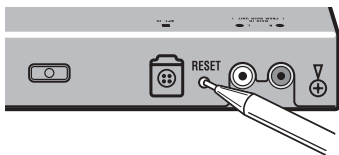

## DVD播放機的輸出設置

當連接DVH-P7050等先鋒DVD播放機時，

**DIGITAL OUTPUT**（設置數碼輸出）和

**OUTPUT SELECTION**（設置數碼和模擬音頻輸出）設置如下：

功能	設置
<b>DIGITAL OUTPUT</b> （數碼輸出）	<b>Dolby D/LPCM</b>
<b>OUTPUT SELECTION</b> （輸出選擇）	<b>48KHz</b>

關於如何進行以上設置的詳細說明，請參閱DVD播放機使用說明書。



重要

- 請務必作正確的設置。否則，將無聲音輸出。□

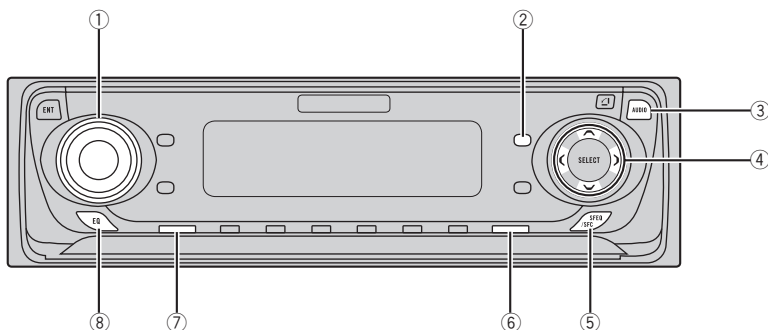

## 按鈕功能

用連接著的主機操作本機。本使用說明書中的說明都以DVH-P7050主機為例。

## 主機

### ① VOLUME（音量）

旋轉調節音量。

當您按動**VOLUME**旋鈕時，它會向外彈出以便您調節。再次按動**VOLUME**旋鈕，則縮回。

### ② FUNCTION（功能）按鈕

按該按鈕可選擇功能。

### ③ AUDIO（音頻）按鈕

按該按鈕可選擇各種音頻功能。

### ④ ▲/▼/◀/▶ 按鈕

按該按鈕可調節已選的音頻功能，並可打開或關閉此功能。

### ⑤ SFEQ/SFC 按鈕

按該按鈕可選擇音場控制。

### ⑥ BAND/ESC（波段/取消）按鈕

按該按鈕可返回至各播放源的顯示畫面。

### ⑦ SOURCE（播放源）按鈕

選擇播放源時本機被打開。按該按鈕在所有播放源之間循環。按住不放可關閉本機。

### ⑧ EQ（等化器）按鈕

按該按鈕可選擇各種等化曲線。▣

## 音頻調節簡介

按下列順序進行設置或調節，您就可以毫不費力地創造一個完美的音場。

- 1 進行揚聲器設置
- 2 使用位置選擇器
- 3 調節時間校正
- 4 使用測試音調節揚聲器輸出音壓
- 5 選擇截止頻率
- 6 調節揚聲器的輸出音壓
- 7 調節3頻帶參量等化器

## 操作音頻菜單



### ① AUDIO顯示區

顯示音頻調節狀態。

### ② 超低音揚聲器指示標誌

當超低音揚聲器輸出打開時出現在顯示屏上。

按**AUDIO**顯示音頻功能名稱。

反覆按**AUDIO**在下列音頻功能之間切換：  
**Posi**（位置選擇器）－ **Fad**（平衡調節）－  
**SLA**（音源級調節）－ **DRC**（動態範圍控制）－ **D.MONO**（雙重單聲道）－ **DI-RECT**（直接）－ **DolbyPL**（杜比專業邏輯）

- 當選擇FM調諧器作為音源時，您無法切換至**SLA**。
- 當播放DVD以外的音源時，您無法切換至**DRC**和**D.MONO**。
- 要回到播放顯示，按**BAND/ESC**。



注意

- 如果您在 30 秒內不操作音頻功能，顯示屏自動回到音源顯示。

## 操作音頻資料菜單

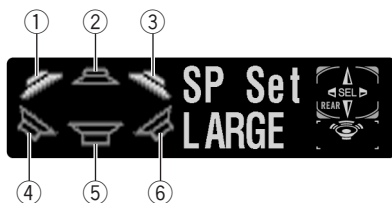

### ① 前置左揚聲器

### ② 中置揚聲器

### ③ 前置右揚聲器

### ④ 後置左揚聲器

### ⑤ 超低音揚聲器

### ⑥ 後置右揚聲器

按**AUDIO**直到**SP Set**出現在顯示屏上，然後按**AUDIO**顯示音頻功能名稱。

**SP Set**顯示後，反覆按**AUDIO**在下列音頻功能之間切換：



## 音頻調節

**SP Set**（揚聲器設置）－ **CutOff**（截止頻率）－ **SP Lev**（揚聲器輸出音壓）－ **T Tone**（測試音）－ **Time A**（時間校正）－ **PEQ**（3頻帶參量等化器）

- 未選擇**Posi**中的**F/L**或**F/R**時，您無法切換至**Time A**。
- 未選擇**CUSTOM1**或**CUSTOM2**作為等化器曲線時，您無法切換至**PEQ**。
- 要回到播放顯示，按**BAND/ESC**。□

### 使用音場控制

SFC功能可創造出現場效果。

- 不同的演奏環境的音效是不同的，它們取決於聲波傳播空間的範圍和形狀以及在此空間中聲音從舞台、牆壁、地板和天花板上反射的方式。在現場演奏會上，您可以聽到三種階段的音樂：直達音、初期反射音和後期反射音，或混音。

這些因素都被編入 SFC 電路中，以便再現各種不同演奏會設置的聲音效果。

按**SFEQ/SFC**選擇所需的**SFC**模式。

反覆按**SFEQ/SFC**在下列模式之間切換：

**Musical**（音樂片）－ **Drama**（戲劇）－ **Action**（動作片）－ **Jazz**（爵士樂）－ **Hall**（音樂廳）－ **Club**（俱樂部）－ **OFF**（關閉）



注意

- 如果音源是一個2聲道LPCM音頻或2聲道杜比數碼音頻，且您選擇最適合5.1聲道音頻的**SFC**效果（如 **Musical**（音樂片），**Drama**（戲劇）或 **Action**（動作片）），我們建議您將杜比專業邏輯打開。另一方面，若**SFC**效果意用於2聲道音頻（如 **Jazz**（爵士樂），**Hall**（音樂廳）或 **Club**（俱樂部））時，我們建議您將杜比專業邏輯關閉。□

### 使用位置選擇器

要確保更自然的聲音的一種方法就是清楚地定位立體聲聲像，使您恰好處於音場的中央。位置選擇器的功能就是使您能自動調節揚聲器的輸出音壓並插入一個延遲時間以便同聽音座位的數目和位置相匹配。當同 SFC 一起使用時，該功能將使立體聲聲像更自然并使您置身於寬廣完整的音域中。

1 按 **AUDIO** 選擇 **Posi**。

按 **AUDIO** 直到 **Posi** 出現在顯示屏上。

2 按 **▲/▼/◀/▶** 選擇一聽音位置。

按 **◀/▶/▲/▼** 其中之一，選擇表格中所列的聽音位置。

按鈕	顯示	位置
◀	F/L	前排左側位置
▶	F/R	前排右側位置
▲	FRONT	前排位置
▼	ALL	所有位置

- 要取消所選的聽音位置，再按一次相同的按鈕。



## 注意

- 當您調節廳音位置時，揚聲器自動設置合適的輸出音壓。您可以根據需要按標題使用測試音調節揚聲器的輸出音壓或調節揚聲器的輸出音壓所述方法進行調整。▣

## 使用平衡調節

您可以選擇衰減器/平衡設置為所有的廳音位置提供一個理想的廳音環境。

## 1 按AUDIO選擇 Fad。

按AUDIO直到 Fad出現在顯示屏上。

- 若平衡設置事先調節過，Bal 將顯示。

## 2 按▲或▼調節前置/後置揚聲器平衡。

每按一下▲或▼將前置/後置揚聲器的平衡向前置或後置移動。

- 當前置/後置揚聲器的平衡從前置向後置移動時，Fad F25 — Fad R25 顯示。
- 若祇使用兩個揚聲器，正確的設置是Fad F/R 0。

## 3 按◀或▶調節左置/右置揚聲器平衡。

當您按◀或▶時，Bal L/R 0 顯示。每按一下◀或▶將左置/右置揚聲器平衡向左置或右置移動。

- 當左置/右置揚聲器的平衡從左向右移動時，Bal L25 — Bal R25 顯示。▣

## 調節音源級

SLA（音源級調節）功能使您在不同的音源之間切換時能調節每個音源的音量級來防止音量發生極大變化。

- 由於FM調諧器的音量級保持不變，設置將以此為依據。

## 1 將FM調諧器音量級和您想調節的音源級相比較。

## 2 按AUDIO選擇SLA。

按AUDIO直到SLA出現在顯示屏上。

## 3 按▲或▼調節音源音量。

每按一下▲或▼增大或減小音源音量。

- 當音源音量增大或減小時，SLA +4 — SLA -4 顯示。



## 注意

- 由於FM調諧器音量起控制作用，故無法對FM調諧器進行音源級調節。
- AM調諧器音量級也能用音源級調節功能來調整。
- VCD和CD自動調節為相同的音量設置。
- 外接設備1和外接設備2自動調節為相同的音量設置。▣

## 音頻調節

### 使用動態範圍控制

動態範圍是指最高和最低聲音之間的音壓差。動態範圍控制將這一壓差進行壓縮，使您即使在音量很低時也能清楚地聽見聲音。

#### 1 按 AUDIO 選擇 DRC。

按 **AUDIO** 直到 **DRC** 出現在顯示屏上。

#### 2 按▲打開動態範圍控制。

**DRC ON** 出現在顯示屏上。動態範圍控制現在打開。

- 您可以按▼關閉動態範圍控制。

#### 注意

- 動態範圍控制祇對杜比數碼聲音有效。
- 當播放DVD以外的音源時，您無法切換該模式。□

### 使用雙重單聲道模式

當播放以雙重單聲道模式錄製的碟片時，您可以選擇輸出的聲道。

#### 1 按 AUDIO 選擇 D.MONO。

按 **AUDIO** 直到 **D.MONO** 出現在顯示屏上。

#### 2 按◀或▶選擇所需的輸出設置。

按◀或▶直到所需的輸出設置出現在顯示屏上。

**L&R**（左右聲道）— **L ch**（左聲道）— **R ch**（右聲道）

#### 注意

- 該功能祇對雙重單聲道模式有效。
- 當播放DVD以外的音源時，您無法切換該模式。□

### 使用直接控制

您可以不理會音頻設置，確認您自己的音頻設置是否有效。

#### 1 按 AUDIO 選擇 DIRECT。

按 **AUDIO** 直到 **DIRECT** 出現在顯示屏上。

#### 2 按▲打開直接控制。

**DIRECT ON** 出現在顯示屏上。直接控制打開。

- 您可以按▼關閉直接控制。

#### 注意

- 在 **DIRECT ON** 狀態下，除 **VOLUME** 所有的音頻功能均被鎖住。□

### 使用杜比專業邏輯

杜比專業邏輯提供增強空間和定向效果，因而能產生如同影劇院一般的現場感和氛圍。

- 如果音源是一個2聲道LPCM音頻或2聲道杜比數碼音頻，且您選擇最適合5.1聲道音頻的SFC效果（如 **Musical**（音樂片），**Drama**（戲劇）或 **Action**（動作片）），我們建議您將杜比專業邏輯打開。另一方面，若SFC效果意用於2聲道音頻（如 **Jazz**（爵士樂），**Hall**（音樂廳）或 **Club**（俱樂部））時，我們建議您將杜比專業邏輯關閉。

## 音頻調節

1 按 **AUDIO** 選擇 **DolbyPL**。

按 **AUDIO** 直到 **DolbyPL** 出現在顯示屏上。

2 按 **▲** 打開杜比專業邏輯。

**DolbyPL ON** 出現在顯示屏上。杜比專業邏輯現在打開。

- 您可以按 **▼** 關閉杜比專業邏輯。

 注意

- 當專業邏輯打開時播放2聲道單聲道音源，下列情況有可能發生：  
未安裝中置揚聲器時，若中置揚聲器設置為 **SMALL** 或 **LARGE**，無音頻輸出。  
安裝了中置揚聲器，且中置揚聲器設置為 **SMALL** 或 **LARGE** 時，音頻祇從中置揚聲器輸出。□

## 進行揚聲器設置

您需要根據所安裝的揚聲器選擇使用/不使用（或是/否）並進行尺寸（低音再現功能）選擇/調節。如果揚聲器可以再現 100 Hz 或以下頻率的聲音，尺寸應設為 **LARGE**（大）。否則請選擇 **SMALL**（小）。

1 按 **AUDIO** 直到 **SP Set** 出現在顯示屏上。2 按 **◀** 或 **▶** 選擇要調節的揚聲器。

每按一下 **◀** 或 **▶** 以下列順序選擇揚聲器：  
前置揚聲器 — 中置揚聲器 — 後置揚聲器 — 超低音揚聲器 — **S.W**（超低音揚聲器設置）

- 祇有當超低音揚聲器設為 **ON** 時，您可以切換至 **S.W**。

3 按 **▲** 或 **▼** 為所選的揚聲器選擇正確的尺寸。

按 **▲** 或 **▼** 直到所需的尺寸出現在顯示屏上。

**LARGE**（大）— **SMALL**（小）— **OFF**（關閉）

- 當選擇了前置揚聲器時，您不能選擇 **OFF**。
- 當選擇了超低音揚聲器時，您可以選擇 **ON** 或 **OFF**。
- 當選擇了 **S.W**（超低音揚聲器設置）時，您可以切換 **Rev.**（反相）或 **Normal**（常相）。

4 按 **BAND/ESC** 回到播放顯示。

## 矯正超低音揚聲器相位

如果增強超低音揚聲器低音輸出的嘗試并無多大效果或您感到低音變得更陰沉，這也許表明超低音揚聲器輸出和您從其他揚聲器收聽到的超低音內容互相抵消了。要解決該問題，請試著改變超低音揚聲器的相位設置。

1 按 **AUDIO** 直到 **SP Set** 出現在顯示屏上。2 按 **◀** 或 **▶** 選擇超低音揚聲器。

按 **◀** 或 **▶** 以下列順序選擇揚聲器：  
前置揚聲器 — 中置揚聲器 — 後置揚聲器 — 超低音揚聲器 — **S.W**（超低音揚聲器設置）

## 音頻調節

- 3 按▲打開超低音揚聲器輸出。
- 4 按▶選擇S.W（超低音揚聲器設置）。
- 5 按▲或▼選擇超低音揚聲器輸出相位。  
按▲選擇 Normal（常相）。按▼選擇Rev.  
（反相）。
- 6 按BAND/ESC回到播放顯示。



## 重要

- 如果超低音揚聲器設為**OFF**，前置和後置揚聲器設為**SMALL**或**OFF**，低頻範圍不輸出。



## 注意

- 請務必將未安裝的揚聲器設置設為**OFF**。
- 如果揚聲器能夠再現超低音內容或者沒有安裝超低音揚聲器，則將前置或後置揚聲器設為**LARGE**。
- 當專業邏輯打開時播放2聲道單聲道音源，下列情況有可能發生：  
未安裝中置揚聲器時，若中置揚聲器設置為 **SMALL** 或 **LARGE**，無音頻輸出。  
安裝了中置揚聲器，且中置揚聲器設置為 **SMALL** 或 **LARGE** 時，音頻祇從中置揚聲器輸出。▣

## 選擇截止頻率

您可以選擇某一頻率，使小於該頻率的聲音通過超低音揚聲器再現。

如果安裝的揚聲器中有一個尺寸設為**SMALL**的揚聲器，您可以選擇一種頻率，使小於該頻率的聲音通過**LARGE**揚聲器或超低音揚聲器再現。

1 按AUDIO直到SP Set出現在顯示屏上，然後按AUDIO選擇CutOff。

SP Set顯示以後，按AUDIO直到CutOff出現在顯示屏上。

2 按◀或▶選擇截止頻率。

每按一下◀或▶以下列順序選擇截止頻率：

**63 – 80 – 100 – 125 – 160 – 200** (Hz)

3 按BAND/ESC回到播放顯示。



## 注意

- 選擇截止頻率就是設置超低音揚聲器的L.P.F.（低通濾波器）和 **SMALL** 揚聲器的H.P.F.（高通濾波器）的截止頻率。  
如果超低音揚聲器設為**OFF**且其他揚聲器設為 **LARGE**或**OFF**，截止頻率設置不起作用。▣

## 調節揚聲器的輸出音壓

現在，您可以重新調節使用測試音調節過的揚聲器音壓。

1 按AUDIO直到SP Set出現在顯示屏上，然後按AUDIO選擇SP Lev。

SP Set顯示以後，按AUDIO直到SP Lev出現在顯示屏上。

## 音頻調節

## 2 按◀或▶選擇要調節的揚聲器。

每按一下◀或▶以下列順序選擇揚聲器：  
前置左揚聲器 — 中置揚聲器 — 前置右揚聲器 — 後置右揚聲器 — 後置左揚聲器 — 超低音揚聲器

- 你不可以選擇尺寸已設置成**OFF**(關閉)的揚聲器。

## 3 按▲或▼調節揚聲器的輸出音壓。

每按一下▲或▼增加或減小揚聲器的輸出音壓。

- 當音壓增加或減小時，**+10** — **-10** 顯示。

## 4 按BAND/ESC回到播放顯示。

 注意

- 該模式下揚聲器的輸出音壓的調節方法與在**T Tone**模式下的調節方法相同。兩者的效果也相同。◻

## 使用測試音調節揚聲器的輸出音壓

合適的測試音使您可以輕鬆自如地獲得揚聲器整體平衡。

1 按**AUDIO**直到**SP Set**出現在顯示屏上，然後按**AUDIO**選擇**T Tone**。

**SP Set**顯示以後，按**AUDIO**直到**T Tone**出現在顯示屏上。

## 2 按▶，開始測試音輸出。

測試音輸出，並以下列順序以2秒為間隔在揚聲器之間循環。發出測試音的揚聲器的當前設置將顯示如下：

前置左揚聲器 — 中置揚聲器 — 前置右揚聲器 — 後置右揚聲器 — 後置左揚聲器 — 超低音揚聲器

確認每個揚聲器的輸出音壓。如果不需要調節，則執行步驟4停止測試音。

- 尺寸設置為**OFF**的揚聲器其設置不顯示。

## 3 按▲或▼調節揚聲器的輸出音壓。

每按一下▲或▼增加或減小揚聲器的輸出音壓。

- 當音壓增加或減小時，**+10** — **-10** 顯示。
- 操作結束後約2秒，測試音將從下一揚聲器開始。

## 4 按◀停止測試音輸出。

## 5 按BAND/ESC回到播放顯示。

 注意

- 如果需要，選擇揚聲器並調節其“絕對”輸出音壓，參見第11頁的**調節揚聲器的輸出音壓**。
- 該模式下揚聲器的輸出音壓的調節方法與在**SP Lev**模式下的調節方法相同。兩者的效果也相同。◻

## 音頻調節

### 調節時間校正

通過調整各揚聲器和所選聽音位置之間的距離，您可以在揚聲器輸出中插入延遲時間，以獲取正確的聲像和整體的音壓平衡。雖然這一操作可在您設置聽音位置時自動完成，但時間校正功能能提供精調。

1 按**AUDIO**直到**SP Set**出現在顯示屏上，然後按**AUDIO**選擇**Time A**。

**SP Set**顯示以後，按**AUDIO**直到**Time A**出現在顯示屏上。

- 若未選擇**Posi**中的**F/L**或**F/R**時，您無法選擇**Time A**。

2 按**◀**或**▶**選擇要調節的揚聲器。

每按一下**◀**或**▶**以下列順序選擇揚聲器：

前置左揚聲器 — 中置揚聲器 — 前置右揚聲器 — 後置右揚聲器 — 後置左揚聲器 — 超低音揚聲器

- 你不可以選擇尺寸已設置成**OFF**（關閉）的揚聲器。

3 按**▲**或**▼**調節所選揚聲器和聽音位置之間的距離。

每按一下**▲**或**▼**增加或減小距離。

- 當距離增加或減小時，**500.0cm — 0.0cm**顯示。

4 按**BAND/ESC**回到播放顯示。◻

### 使用等化器

使用參量等化器可以調節等化，以適應汽車內部的聲音特性。

### 調出等化器曲線

本機存有7種等化器曲線，您可以隨時將其調出。等化器曲線列表顯示如下：

顯示	等化器曲線
<b>SUPER BASS</b>	超低音
<b>POWERFUL</b>	強勁
<b>NATURAL</b>	自然
<b>VOCAL</b>	唱聲
<b>FLAT</b>	無效果
<b>CUSTOM1, 2</b>	客戶1, 2

- **CUSTOM1**和**CUSTOM2**是調節好的等化器曲線，您可以根據您的需要進行創建。
- 當選擇**FLAT**時，不對聲音進行任何補償和矯正。但它對確認等化器曲線效果十分有用，您可以在**FLAT**和一系列等化器曲線之間交替切換以確認效果。

### 按EQ選擇等化器

反覆按**EQ**在下列等化器之間切換：

**POWERFUL — NATURAL — VOCAL — FLAT — CUSTOM1 — CUSTOM2 — SUPER BASS** ◻

### 調節3頻帶參量等化器

對於CUSTOM1和CUSTOM2等化器曲線，您可以分別調節前置、後置和中置等化器曲線，為每一頻帶選擇一中心頻率、等化度和一個Q因子。

- 可以為每一種音源創建一條單獨的CUSTOM1曲線。
- 可以為所有音源創建一條共同的CUSTOM2曲線。

● 中置揚聲器基本上決定了聲像，使揚聲器系統不太容易達到正常平衡。因此我們建議播放2聲道音頻（如CD），使中置揚聲器以外的揚聲器平衡達到正常，然後再播放5.1聲道音頻（杜比數碼或DTS），將中置揚聲器的輸出調節至您在其他揚聲器中設定好的平衡狀態。

**1 按AUDIO直到SP Set出現在顯示屏上，然後按AUDIO選擇PEQ。**

SP Set顯示以後，按AUDIO直到PEQ出現在顯示屏上。

- 若未選擇CUSTOM1或CUSTOM2等化器曲線，您無法選擇PEQ。

**2 按◀或▶選擇揚聲器選擇模式。**

每按一下◀或▶以下列順序顯示項目：

**FRONT**（揚聲器）— **Low**（頻帶）— **Low**（中心頻率）— **L**（等化度）— **Q.WIDE**（Q因子）

**3 按▲或▼選擇要調節的揚聲器。**

每按一下▲或▼以下列順序選擇揚聲器：

**FRONT**（前置揚聲器）— **CENTER**（中置揚聲器）— **REAR**（後置揚聲器）

- 你不可以選擇尺寸已設置成**OFF**（關閉）的揚聲器。

**4 按▶，然後按▲或▼選擇要調節的等化器頻帶。**

每按一下▲或▼以下列順序選擇等化器頻帶。

**Low**（低頻帶）— **Mid**（中頻帶）— **High**（高頻帶）

**5 按▶，然後按▲或▼選擇所選頻帶的中心頻率。**

每按一下▲或▼以下列順序選擇頻率：

**100—125—160—200—250—315—400—500—630—800—1k—1.25k—1.6k—2k—2.5k—3.15k—4k—5k—6.3k—8k** (Hz)

**6 按▶，然後按▲或▼調節等化度。**

每按一下▲或▼增加或減小等化度。

- 當等化度增加或減小時，**+6—-6**顯示。

**7 按▶，然後按▲或▼選擇要調節的Q因子。**

每按一下▲或▼以下列順序選擇Q因子。

**Q.WIDE**（寬）— **Q.NAR.**（窄）。

- 您可用相同的方法調整其它揚聲器各個頻帶的參數。

**8 按BAND/ESC回到播放顯示。**



注意

- 您可以為每一頻帶從20種頻率中選擇一個中心頻率。您可以以1/3倍頻程的間隔來改變中心頻率，但這樣做無法選擇頻率，所以三個頻帶的中心頻率之間的間隔將小於1個倍頻程。□



## 初始設置

### 矯正失真聲音

根據等化器曲線設置，您可以將可能產生的失真降至最小。

- 設置較高的等化度可能會引起失真。如果高音削弱或失真，請嘗試**Low**。一般來說，將設置保留為**High**以確保音質。

1 按**SOURCE**直到本機關閉。

2 按**FUNCTION**直到功能名稱出現在顯示屏上。

3 按**FUNCTION**選擇**D.ATT**。

按**FUNCTION**直到**D.ATT**出現在顯示屏上。

4 按◀或▶選擇**Low**或**High**。

按◀或▶在**Low**（低頻帶）和**High**（高頻帶）之間切換，且其狀態顯示出來。

- 要取消初始設置，按**BAND/ESC**。
- 按**FUNCTION**直到本機關閉也可以取消初始設置。◻

## 故障追尋

### 一般問題

症狀	原因	對策
電源不工作。 沒有功能出現。	電纜或接口連接不正確。	檢查電纜是否正確牢靠地插入。
	熔絲燒斷。	排除熔絲燒斷的起因，然後更換熔絲。 務必確保安裝合適的相同額定值的熔絲。
聽不到聲音。 音量位準提不高。	電纜連接不正確。	正確連接電纜。
	前、後、左、右揚聲器的位準平衡調整不合適。	正確調整揚聲器之間的相關位準。 (見第8頁。)
某個特定揚聲器沒有聲音。	揚聲器尺寸設定為 <b>OFF</b> (關)。	給揚聲器設定正確的尺寸。 (見第10頁。)
	揚聲器位準設在太低的位置。	提高揚聲器位準設定使與其他揚聲器達成適合的平衡。(見第11頁。)
	中央揚聲器尺寸設定為 <b>SMALL</b> (小) 或 <b>LARGE</b> (大)，而中央揚聲器卻未安裝。	將中央揚聲器尺寸設為 <b>OFF</b> (關)。 (見第10頁。)

## 附加資訊

## 音響/DSP

症狀	原因	對策
揚聲器不能被調節。	尺寸設定為 <b>OFF</b> （關）。	正確設定尺寸。（見第10頁。）
時間校準無法使用。	收聽位置設定得不正確。	正確設定收聽位置。（見第7頁。）
	尺寸設定為 <b>OFF</b> （關）。	正確設定尺寸。（見第10頁。）
超低音揚聲器相位無法切換。	超低音揚聲器設定為 <b>OFF</b> （關）。	將超低音揚聲器設為 <b>ON</b> （開）。（見第10頁。）
聽不到低音。	超低音揚聲器設定為 <b>OFF</b> （關），且有其他揚聲器設定為尺寸 <b>OFF</b> （關）或 <b>SMALL</b> （小）。	正確設定。（若沒有安裝超低音揚聲器，則前或後揚聲器要設為 <b>LARGE</b> （大）。（見第10頁。）
當杜比定向邏輯接入時，有時候沒有聲音輸出。	中央揚聲器設定為 <b>SMALL</b> （小）或 <b>LARGE</b> （大），而中央揚聲器卻未安裝。	將中央揚聲器尺寸設定為 <b>OFF</b> （關）。（若是單聲音頻源且接入杜比定向邏輯，則僅能在中央揚聲器上聽到聲音。）（見第10頁。）
除中央揚聲器外，有時候聽不到其他揚聲器的聲音。	杜比定向邏輯接入。	將杜比定向邏輯設定為 <b>OFF</b> （關）。（若是單聲音頻源且接入杜比定向邏輯，則僅能在中央揚聲器上聽到聲音。）（見第9頁。）
將動態範圍控制切換為 <b>ON</b> （開）沒有效果。	當前複現的聲音不是杜比數碼編碼的。	此項性能僅對杜比數碼聲有效。（見第9頁。）

## DVD播放器設定

症狀	原因	對策
僅有的DVD播放機沒有聲音。	光纜已拆下。	正確連接電纜。
	DVD播放機的輸出設定不恰當。	正確設定輸出。（見DVD播放機的使用說明書。）



## 術語

### Dolby Digital (杜比數碼)

杜比數碼提供數碼多通道(最多5.1)音頻,這與電影院中安裝的音響系統相同。為享受杜比數碼音響您需把本機的光纖數碼輸入與具有杜比數碼解碼能力的DVD播放機數碼輸出連接。



### Dolby Surround Pro Logic (杜比環繞定向邏輯)

當您使用配有杜比定向邏輯的AV(視聽)放大器播放標有杜比環繞定向邏輯的2通道音頻碟片時,音頻被轉為4通道音頻。杜比定向邏輯可提供增強的空間感和方位感,提供影院效果的現場感和氛圍。

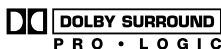

### DTS-數碼影院環繞

DTS是一個可從最多6個獨立音源中傳送多聲道音頻的環繞聲系統。若要收聽DTS碟片,您需把有DTS功能的DVD播放機或其它設備的數碼輸出連接到本機的數碼輸入上。



### Dynamic Range Control (動態範圍控制)

杜比數碼可提供動態範圍控制功能,它可將最響和最弱的音響之間的差別減小。此項控制保證聲音有增大的動態範圍,即使在低的音量位準下也聽得很清楚。

### 線性PCM (LPCM) / 脈波編碼調制

這是音樂CD上使用的錄製技術。某些DVD-視頻碟片也包含有PCM聲軌,音樂CD以44.1kHz/16比特錄製,而DVD-視頻碟片的聲軌以48kHz/16比特到96kHz/24比特錄製,因而可提供比音樂CD更佳的效果。

### Optical Digital Input (光纖數碼輸入)

用光纖數碼輸入接收數碼格式的音頻訊號,可以最大地減小傳輸中聲音訊號質量的降低。光纖數碼輸入指通過光接收數碼訊號。(為利用數碼輸入、輸出設備如DVD播放機必須具有光纖輸出。) □

## 附加資訊

## 規格

## 一般

電源	14.4 VDC(容許範圍 10.8 - 15.1 V)
接地系統	負極型
最大電流消耗:	
後備電流	10 A
尺寸(寬×高×深)	237×29×171 mm
重量	1.05 kg

## 功放

各聲道連續輸出功率為22 W，最小負荷4 Ω，聲道範圍50至15,000 Hz，儘5%THD。

最大輸出功率 ..... 50 W×5

負載阻抗 ..... 4 Ω

前輸出最大輸出電平 .. 5.0 V

解碼器 ..... 線性PCM / 杜比數碼 /  
杜比定向邏輯 /  
數碼影院環繞

## 超低音輸出:

    分隔頻率 ..... 63/80/100/125/160/200 Hz

    等級 ..... ±10 dB

## 揚聲器設置:

    時間校正 ..... 0-500 cm (2.5 cm)

    等級 ..... ±10 dB

## 等化器:

    頻帶 ..... 3頻帶

    頻率 ..... 100/125/160/200/250/  
315/400/500/630/800/  
1k/1.25k/1.6k/2k/2.5k/  
3.15k/4k/5k/6.3k/8k Hz

    等級 ..... ±12 dB

    分隔頻率 ..... 63/80/100/125/160/200 Hz



## 注意

- 規格和設計若因改進有所變更，恕不另行通知。□







## **PIONEER CORPORATION**

4-1, MEGURO 1-CHOME, MEGURO-KU, TOKYO 153-8654, JAPAN

### **PIONEER ELECTRONICS (USA) INC.**

P.O. Box 1540, Long Beach, California 90801-1540, U.S.A.  
TEL: (800) 421-1404

### **PIONEER EUROPE NV**

Haven 1087, Keetberglaan 1, B-9120 Melsele, Belgium  
TEL: (0) 3/570.05.11

### **PIONEER ELECTRONICS ASIACENTRE PTE. LTD.**

253 Alexandra Road, #04-01, Singapore 159936  
TEL: 65-472-1111

### **PIONEER ELECTRONICS AUSTRALIA PTY. LTD.**

178-184 Boundary Road, Braeside, Victoria 3195, Australia  
TEL: (03) 9586-6300

### **PIONEER ELECTRONICS OF CANADA, INC.**

300 Allstate Parkway, Markham, Ontario L3R OP2, Canada  
TEL: (905) 479-4411

### **PIONEER ELECTRONICS DE MEXICO, S.A. de C.V.**

San Lorenzo 1009 3er. Piso Desp. 302  
Col. Del Valle Mexico, D.F. C.P. 03100  
TEL: 55-5688-52-90

## **先鋒股份有限公司**

總公司：台北市中山北路二段44號13樓  
電話：(02) 2521-3588

## **先鋒電子（中國）有限公司**

香港辦事處：香港銅鑼灣告士打道280號世界貿易中心  
17樓 1704-06室  
電話：(0852) 2848-6488

Published by Pioneer Corporation.  
Copyright © 2002 by Pioneer Corporation.  
All rights reserved.

Publication de Pioneer Corporation.  
Copyright © 2002 Pioneer Corporation.  
Tous droits de reproduction et de traduction  
réservés.